



VZ-PVM-Z4B2 ADVANTAGES

- 32" HD Public View Monitor
- "A" Commercial Grade LED
- Built in 2.1 Mega Pixel Camera
- Camera Motion Sensor
- Timed Source Switching
- Auto Power / Source Recovery
- 600 TV Line - Analog Video Resolution
- PIP / PBP / VOV
- BNC(NTSC/PAL), VGA, 2 HDMI, DVI, PC Stereo
- 3D Comb-filter, De-interlace
- 3-Year Warranty



| MODEL # | | VZ-PVM-Z4B2 |
|---|--|---|
| DISPLAY | | |
| Screen Size | 32" | |
| Max. Resolution | 1920 x 1080 @60Hz | |
| Pixel Pitch | 0.36375mm x 0.36375mm | |
| Brightness | 350cd/m ² (Typical) | |
| Contrast Ratio | 3000:1 | |
| Aspect Ratio | 16 : 9 | |
| Viewing Angle (H/V) | 178° / 178° | |
| Display Color | 16.7 Million | |
| Response Time | < 6.5 ms | |
| Video System | NTSC / PAL | |
| Frequency (H) / Frequency (V) | 31 ~ 80Khz / 56 ~ 75Hz | |
| INTERFACE | | |
| AV (Composite) In / Out | 1 / 1 | |
| Camera Out | 1 | |
| DVI - In / HDMI In / VGA In (15Pin D-Sub) | 1 / 2 / 1 | |
| PC Stereo In / Out | 1 / 1 | |
| SPECIAL FEATURES | | |
| Multi Display Function | PIP / PBP / VOV | |
| Filter Type | 3D Comb-filter / De-Interlace | |
| Analog Video Resolution (MAX) | 600 TV Line | |
| Multi-lingual Language | English, Spanish, French, German, Italian, Portuguese, Dutch | |
| DIMENSIONS & WEIGHT | | |
| Outline Dimension (W x H x D) | 28.86" x 20.52" x 3.58" | |
| | 733mm x 521.2mm x 91mm | |
| Net Weight / Gross Weight | 36.82 lbs (16.7kg) / 46.3 lbs (21 kg) | |
| MOUNT | | |
| VESA | 200mm x 200mm / M6 x 8 Screws | |
| GENERAL | | |
| Transmitter - IR Remote Control | YES | |
| Power | Electrical Ratings | 24V AC |
| | Consumption | 66W |
| Warranty | Parts / Labor | 3 Year / 3 Year |
| | MTBF (Approx.) | 50,000 Hours |
| Operating Temperature | 32 - 104°F / 0 - 40°C | |
| Regulation | TUV-NRTL (=UL), FCC(A) | |
| Compatible Mounts | Wall | VZ-WM50, VZ-AM02 |
| | Ceiling | VZ-CMKIT-01, VZ-CMKIT-02, VZ-CM06, VZ-CM-18 |

| CAMERA | |
|--------------------------------------|---|
| Camera Type | 2.1 Mega Pixel Camera |
| Image Sensor | Panasonic 2.1 Mega Pixel C-MOS Sensor |
| Lens | DC Auto Iris 2.8~12mm Vari-focal Lens |
| Active Pixels | 1920(H) x 1080p(V) 30fps |
| Video Out | 1ch CVBS (NTSC/PAL) |
| Motion Detection Function | Support |
| | 2D/3D NR, D-ZOOM, DPC, HLC/BLC, Defog D/N, DWDR, AGC, AWB, IR SMART |
| Min Illumination | 0.5 Lux@50IRE, F1.2 |
| MEDIA CARD - Optional Feature | |
| Support Type | Photo, Music, Video |
| Support File Format | MPEG1, MPEG4, JPEG, BMP, GIF, PNG, MP3 |
| External Storage | Support USB1.1, USB2.0 SD (4in1)/MMC/MS/XD |
| VIDEO Resolution | 720 X 576 |

Contact ViewZ

- Address : 177 W. Orangethorpe Ave., Placentia, CA 92870
- Phone : (714) 996-1177, Fax : (714) 996-1138
- Sales : sales@viewzusa.com
- Specification subject to change without notice.

DIMENSIONS

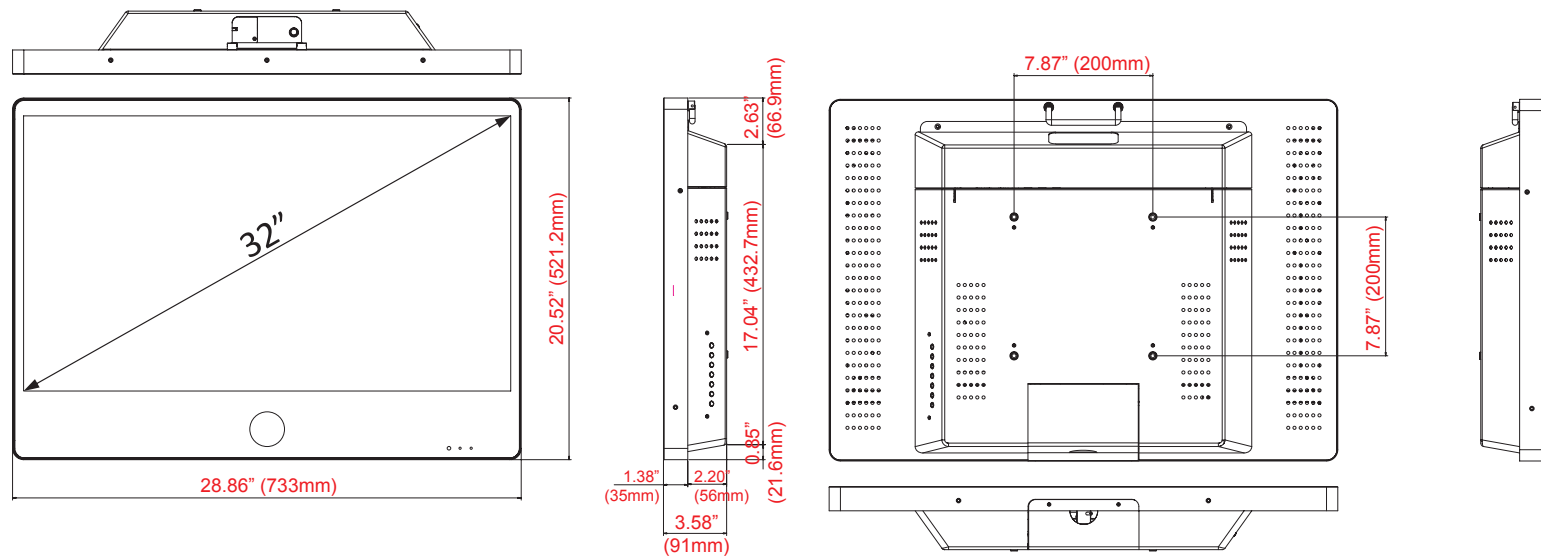

INTERFACE

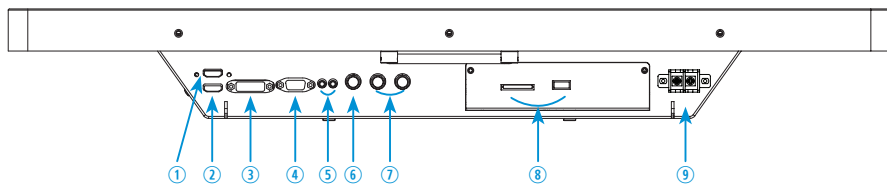

1. HDMI2 IN
2. HDMI1 IN
3. VGA IN
4. DVI IN
5. PC STEREO IN/AUDIO OUT
6. CAMERA OUT
7. AV(composite)2 IN/OUT
8. MEDIA CARD(USB, SD) - Optional
9. AC 24V IN

Contact ViewZ

- Address : 177 W. Orangethorpe Ave., Placentia, CA 92870
- Phone : (714) 996-1177, Fax : (714) 996-1138
- Sales : sales@viewzusa.com
- Specification subject to change without notice.