

1/2" Vari-Zoom with Video Auto-IRIS / F, Z: Manual 8.5–51mm F1.6 – C-Mount

Compatible with 1/2", 1/3" Cameras

SPECIFICATIONS

6X Vari Zoom Lens

Focal Length	8.5 ~ 51 mm
Maximum Relative Aperture	1:1.6
Iris	F1.6 - Approx. 360 (With ND Spot Filter)
Angular Field of View	41.3° x 31.5° at 8.5 mm 7.2° x 5.4° at 85 mm
Image Format	6.4 x 4.8 mm (Ø8 mm)
Minimum Object Distance	0.8 m (From Front Vertex)
Optical Back Focal Distance	15.89 mm (In Air)
Flange Back	17.526 mm
Input Signal	Composite Video Signal or Video Signal
Sensitivity Adjustment	0.5 ~ 1.0Vp-p (Image Signal)
Photometry Range	Approx. 40% - 70% Variable to Vp-p

Input Impedance	High Impedance
Operation	Zoom Manual
	Focus Manual
	Iris EE (DC+8 to 16V : Max 40mA)
EE Mechanism	The built-in EE Amp amplifies the difference between the video signal from the camera and the preset Iris signal level. It causes the Iris to change size.
EE Accuracy :	With Input Video Signal 0.7Vp-p Within ± 10% of Mean Value
Operation Temperature	- 10 °C ~ 50 °C / 14 °F ~ 122 °F
Mount	C-Mount (Adjustable Lens Position)
Size, Weight	Ø43.6 x 59(W) x 48(H) x 72.6(D) mm, Approx. 140g

DIMENSIONS

UNIT: mm

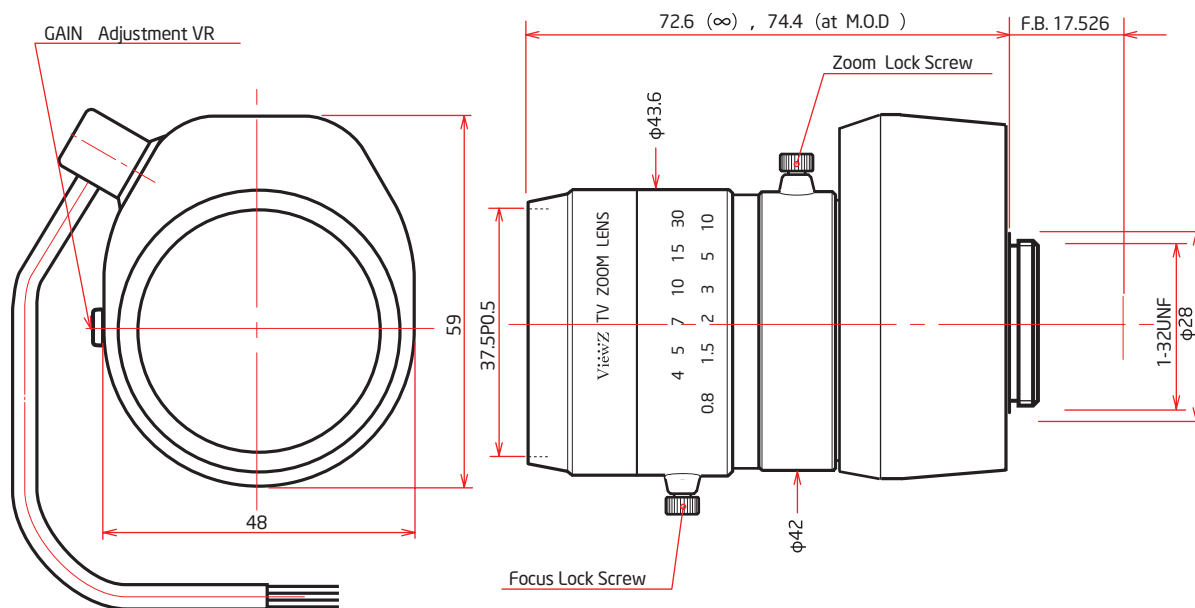

CIRCUIT DIAGRAM

